

PRODUCT DATASHEET

Model: LLR15

Category: LED Module

Description: 12w LED Module



General Information

Material: Aluminum

Fitting Colors: Metallic Grey

Rotation Angle (degree): Not Applicable

Tilting Angle (degree): Not Applicable

Track System: Not Applicable

IP Rating: IP20

Working Temperature (°C): -5 - +35

Storage Temperature (°C): -20 - +50



Product Dimensions and Cut-out Information

Fitting Length (mm): Not Applicable

Diameter (mm): 50

Height (mm): 60

Cut-out Dimension (mm): Not Applicable

Dimension:

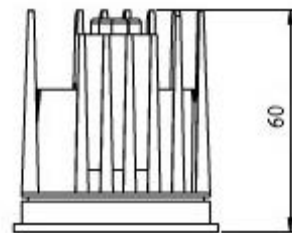

Lifespan

Lifetime (hours): 50000

Luminous Flux after 50000hours (lm): LM80 Comply

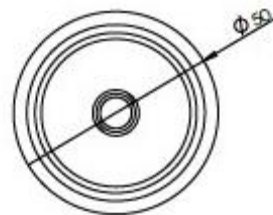

PRODUCT DATASHEET

Model: LLR15

Category: LED Module

Description: 12w LED Module



Light Technical Information

Color Temperature	CRI (Ra)	System Lumen	Lumen per Watt
2700	90	1022	74
2700	95	964	70
3000	90	1063	77
3000	95	984	71
4000	90	1148	83
4000	95	1059	77
5000	90	1239	89

LED Manufacturer: Luminus

LED Type: COB

LED Model: CXM-9 Gen 4

Optic: Reflector

Beam Angle (°): 25°/43°/60°

Electrical Information

System Power (w): 13.9

Input Voltage (v) & Frequency: 220-240V 50/60Hz

Output Voltage (v): 31-37

Current (mA): 350mA

Non-Dimmable: Tridonic (LC 15W/350/42 fixC SC ADV2)

Power Factor: ≥ 0.55

Efficiency (%): 88

Total Harmonic Distortion (%): $c \leq 15$

Ripple (%): ± 5

Dimmable: Triac Dimming – Upon Request

1-10V Dimming – Upon Request

Dali Dimming – Upon Request